

○ CURVE DATA TABLE

ID	Rc	Δc	Lc	Tc	θs1	θs2	Ls1	Ls2	Ea	Eu	V(mph)	
L9					SEE SHEET L-5							
L10	300'	3°41'09"	19.30'	9.65'	2°51'53"	2°51'53"	30'	30'	0.0"	0.84"	8	
L11	300'	6°53'48"	36.11'	18.08'	2°51'53"	2°51'53"	30'	30'	0.0"	0.84"	8	
L12	1200'	0°47'52"	16.71'	8.35'	0°42'58"	0°42'58"	30'	30'	0.0"	0.95"	17	
L13	1200'	0°49'24"	17.24'	8.62'	0°42'58"	0°42'58"	30'	30'	0.0"	0.95"	17	
R13	500'	6°09'37"	53.76'	26.90'	1°43'08"	1°43'08"	30'	30'	0.0"	1.28"	15	
R14	500'	6°12'44"	54.21'	27.13'	1°43'08"	1°43'08"	30'	30'	0.0"	1.28"	15	

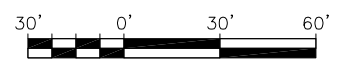

SCALE: 1"=30'

NO.	REVISION	BY	DATE	RECORD DRAWING DATE:
SCALE				HORIZONTAL: AS NOTED
				VERTICAL: N/A
PROJECT NO.				
CAD FILE:				

DESIGN: TVK  
 DRAWN: VWF  
 CHECKED: JH  
 APPROVED: \_\_\_\_\_

**PRELIMINARY  
 ENGINEERING  
 NOT FOR  
 CONSTRUCTION**

**CITY OF WEST SACRAMENTO  
 ENGINEERING DIVISION**  
 1110 WEST CAPITOL AVENUE  
 WEST SACRAMENTO, CA 95691



**HDR**  
 2365 Iron Point Road  
 Suite 300  
 Folsom, CA 95630  
 (916) 817-4700

**DOWNTOWN/RIVERFRONT STREETCAR PROJECT**

**TRACK ALIGNMENT**

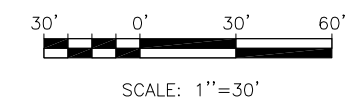
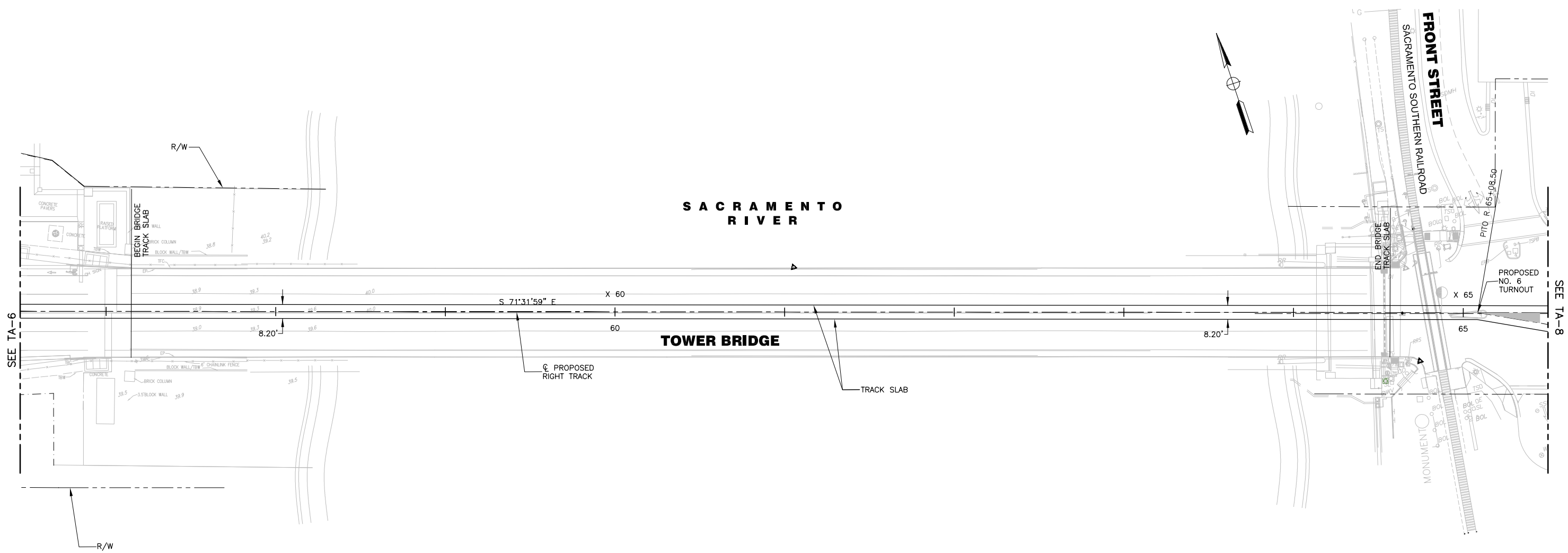

NO.	REVISION	BY	DATE	RECORD DRAWING DATE:
				SCALE
				HORIZONTAL: AS NOTED
				VERTICAL: N/A
				PROJECT NO.
				CAD FILE:

DESIGN: TVK  
 DRAWN: VWF  
 CHECKED: JH  
 APPROVED: \_\_\_\_\_

**PRELIMINARY  
 ENGINEERING  
 NOT FOR  
 CONSTRUCTION**

**CITY OF WEST SACRAMENTO  
 ENGINEERING DIVISION**  
 1110 WEST CAPITOL AVENUE  
 WEST SACRAMENTO, CA 95691



**HDR**  
 2365 Iron Point Road  
 Suite 300  
 Folsom, CA 95630  
 (916) 817-4700

**DOWNTOWN/RIVERFRONT STREETCAR PROJECT**

---

**TRACK ALIGNMENT**

15 OF 105  
 TA-7  
 DWG. NO.



SEE L-5

SEE L-7

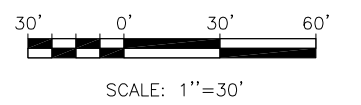
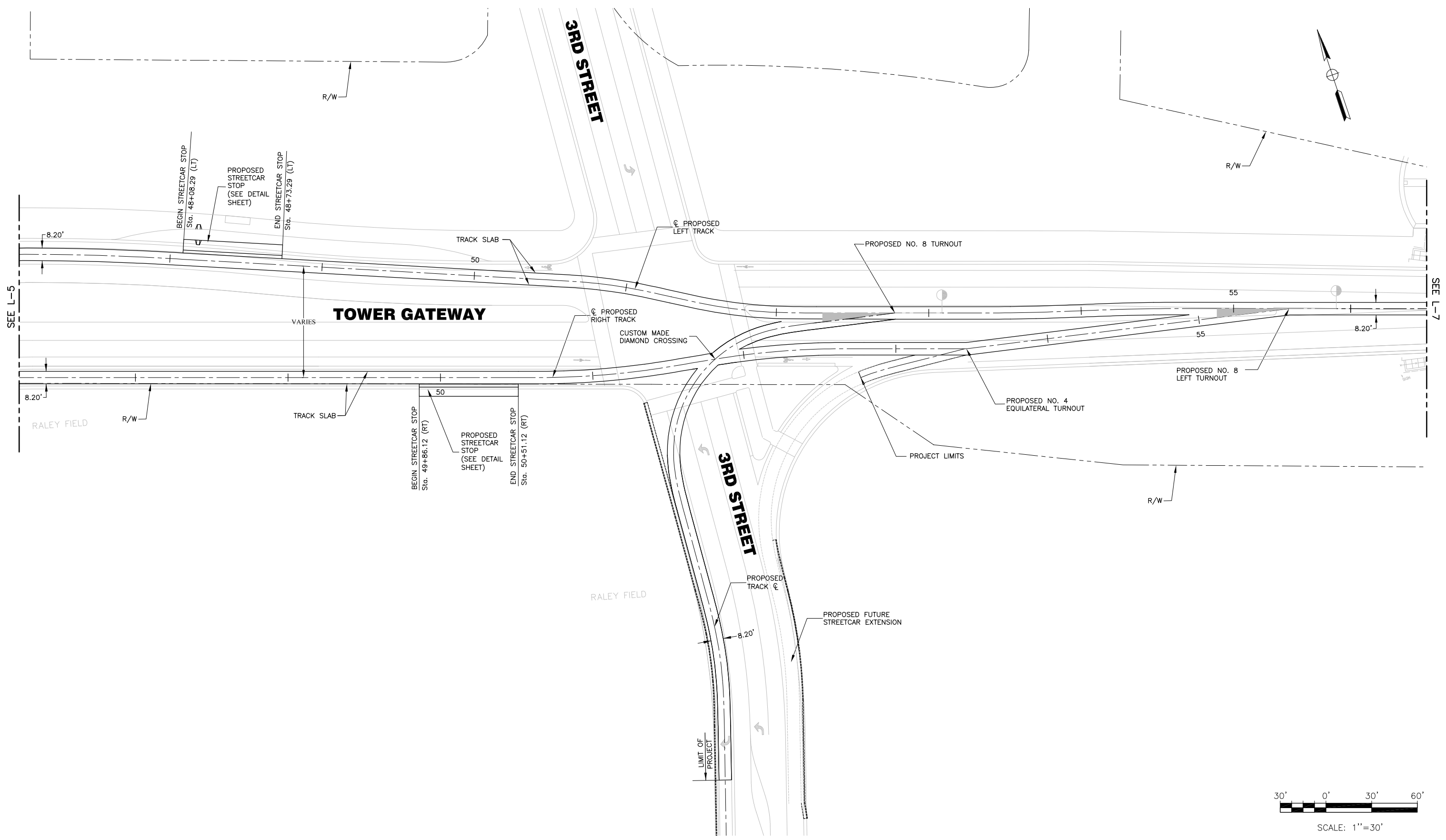

NO.	REVISION	BY	DATE	RECORD DRAWING DATE:
SCALE				HORIZONTAL: AS NOTED
				VERTICAL: N/A
PROJECT NO.				
CAD FILE:				

DESIGN: TVK  
 DRAWN: VWF  
 CHECKED: JH  
 APPROVED: \_\_\_\_\_

**PRELIMINARY  
 ENGINEERING  
 NOT FOR  
 CONSTRUCTION**

**CITY OF WEST SACRAMENTO  
 ENGINEERING DIVISION**  
 1110 WEST CAPITOL AVENUE  
 WEST SACRAMENTO, CA 95691



**HDR**  
 2365 Iron Point Road  
 Suite 300  
 Folsom, CA 95630  
 (916) 817-4700

**DOWNTOWN/RIVERFRONT STREETCAR PROJECT**

**LAYOUT PLAN**

29 OF 105  
 L-6  
 DWG. NO.

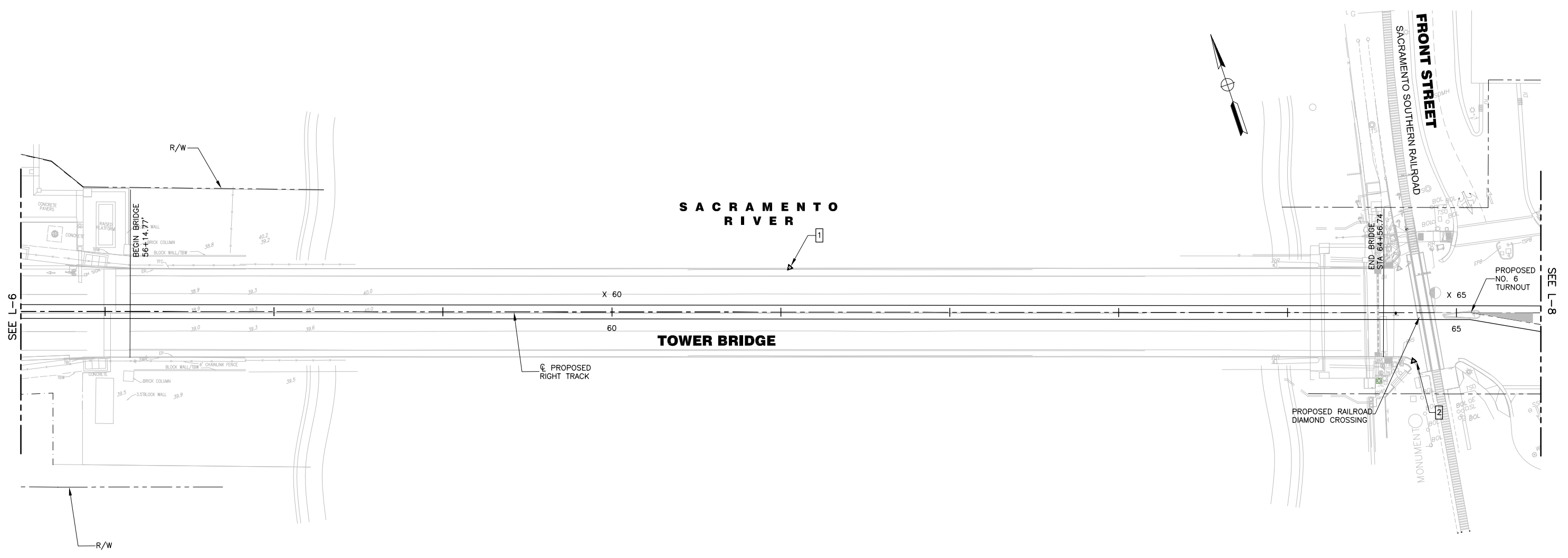

EXISTING SURVEY MONUMENTS

No.	STATION	NORTHING	EASTING	DESCRIPTION
1.	61+05.23	1973662.39	6702214.42	ON THE TOWER BRIDGE
2.	64+74.49	1973493.29	6702547.25	EAST END OF TOWER BRIDGE

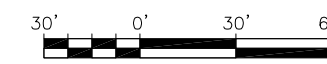

SCALE: 1"=30'

NO.	REVISION	BY	DATE	RECORD DRAWING DATE:

DESIGN:	TVK
DRAWN:	VWF
CHECKED:	JH
APPROVED:	_____

**PRELIMINARY  
ENGINEERING  
NOT FOR  
CONSTRUCTION**

**CITY OF WEST SACRAMENTO  
ENGINEERING DIVISION**  
1110 WEST CAPITOL AVENUE  
WEST SACRAMENTO, CA 95691



**HDR**  
2365 Iron Point Road  
Suite 300  
Folsom, CA 95630  
(916) 817-4700

**DOWNTOWN/RIVERFRONT STREETCAR PROJECT**

---

**LAYOUT PLAN**

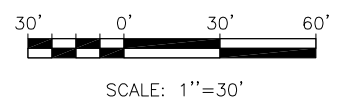
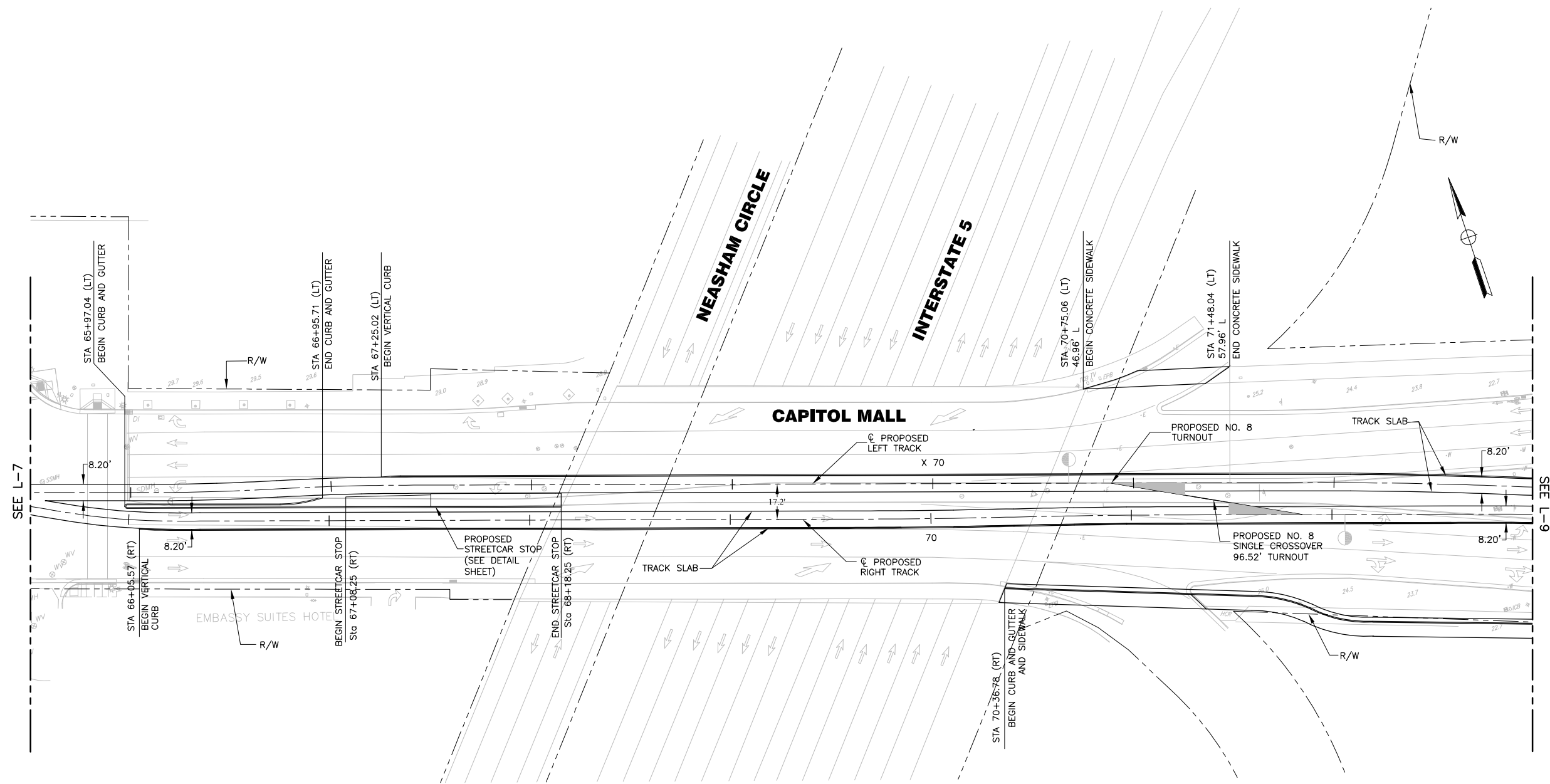

NO.	REVISION	BY	DATE	RECORD DRAWING DATE:
SCALE				HORIZONTAL: AS NOTED
				VERTICAL: N/A
PROJECT NO.				
CAD FILE:				

DESIGN: TVK  
 DRAWN: VWF  
 CHECKED: JH  
 APPROVED: \_\_\_\_\_

**PRELIMINARY  
 ENGINEERING  
 NOT FOR  
 CONSTRUCTION**

**CITY OF WEST SACRAMENTO  
 ENGINEERING DIVISION**  
 1110 WEST CAPITOL AVENUE  
 WEST SACRAMENTO, CA 95691



**HDR**  
 2365 Iron Point Road  
 Suite 300  
 Folsom, CA 95630  
 (916) 817-4700

**DOWNTOWN/RIVERFRONT STREETCAR PROJECT**

---

**LAYOUT PLAN**

31 OF 105  
 L-8  
 DWG. NO.